



WOOD AND WOOD/ALUMINIUM ENTRANCE DOORS

WOOD

- ☐ You can choose from the following species of wood: spruce, pine, larch, oak and meranti.
- ☐ The wood meets the RAL quality requirements according to EN 942
- ☐ The moisture content of the wood is controlled and amounts to 13 +/- 2%.
- ☐ Wood is stored in regulated air humidity warehouse, which prevents cracking and other defects related to inadequate moisture content in the wood.



WOOD PROFILES

- ☐ Wood frame and leaf profiles with a thickness of 68, 80 mm.
- ☐ The profiles are three layers of wood joined together using waterresistant D4 adhesive according to the EN 204 and EN 14257 standards.
- ☐ The mullion of the door leaves of the CLASSIC range include aluminium and steel stabilisers to prevent the leaf bending.

HARDWARE

- ☐ Quality three-dimensional adjustable standard Baka PROTECT 4010 3D FD hinges (HH 68) and concealed hinges Tectus TE 540 3D (HH80).
- ☐ 3 or 5-point locking of the leaf.
- ☐ Various options for opening: outside opening, a fingerprint system, electrical opening etc.



GLAZING

- ☐ You can choose from a variety of thermal and acoustic insulated and safety glass.
- ☐ A wide selection of ornaments and vitrages according to your wishes.
- ☐ Finishing the glass with various foils, glass accessories, sandblasting etc.

SURFACE TREATMENT

- ☐ You will surely find a colour shade to your taste from our wide range of various coatings.
- ☐ Optional two-coloured version.





VIEW FROM OUTSIDE



VIEW FROM THE INSIDE



Opening the door with dLine Fingerprint



Handle with an integrated Fingerprint reader dLine



Handle with an integrated LED light



LED light

CROSS SECTIONS

WOOD/ALUMINIUM ENTRANCE DOORS **INO-HAH**

with aluminum cladding
thickness **80** mm

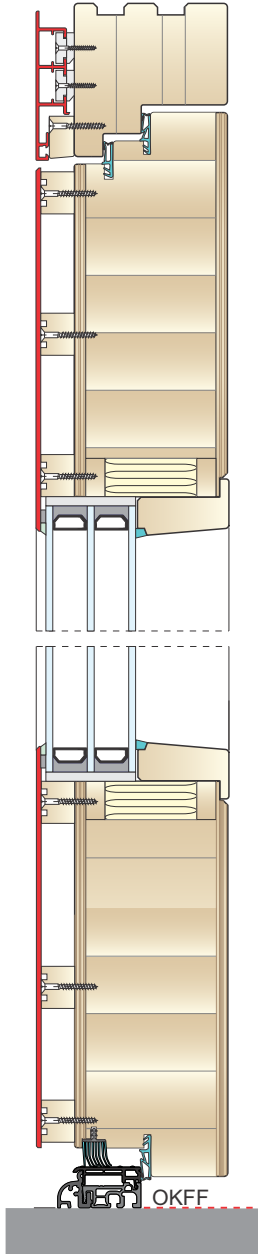

Series **TREND ALPHA**

with aluminum cladding
thickness **80/78** mm

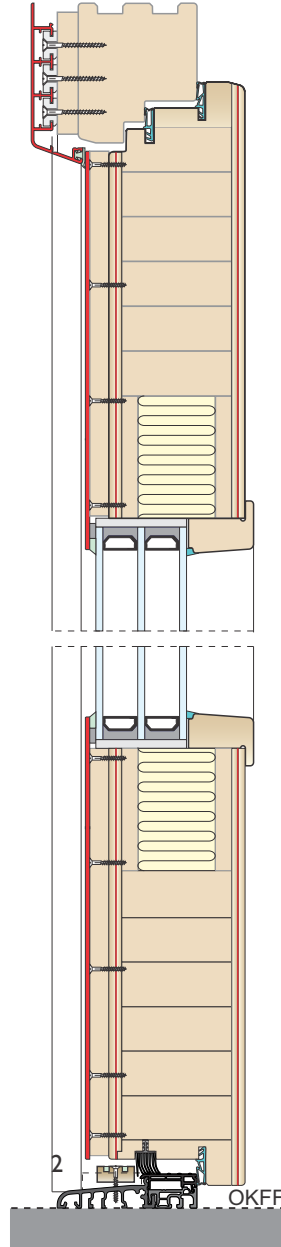

Series **TREND, DELUXE
MODERN**

Wood thickness 68 mm	<p>STANDARD VERSION ANGULAR EDGES glazing bar</p>	<p>ADDITIONAL OFFER PROFILED EDGES glazing bar</p>	<p>ADDITIONAL OFFER ROUNDED EDGES glazing bar</p>

WOOD ENTRANCE DOORS **INO-HH**

Frame with aluminum cladding

thickness **80/ 80** mm

thickness **80/ 80** mm

thickness **68/ 95** mm

wood- thickness **68/ 95** mm

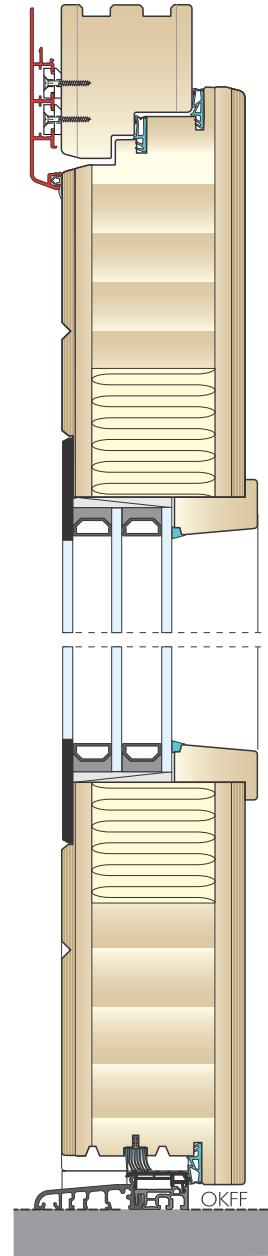
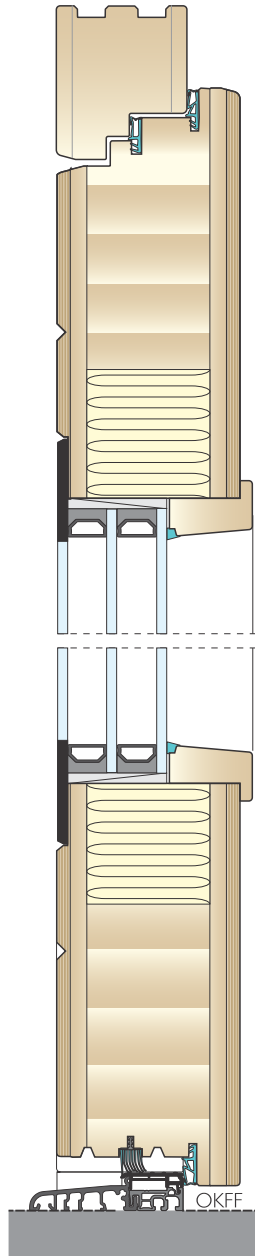
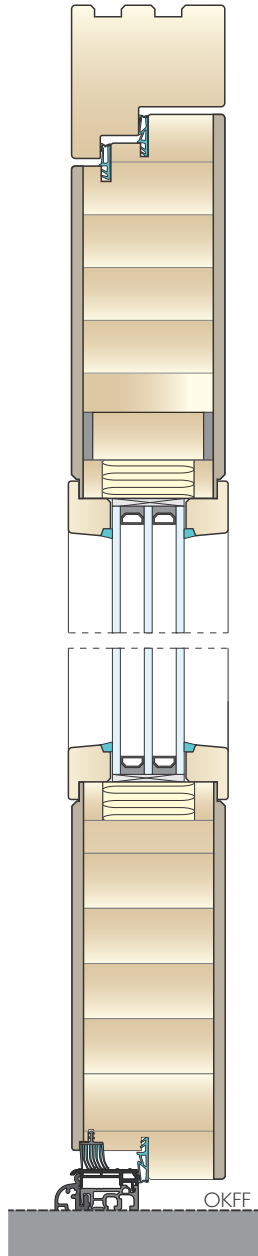
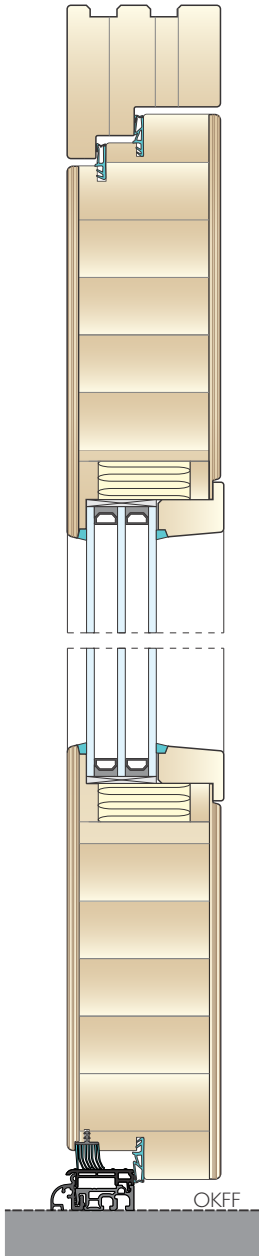

Series **TREND ALPHA**

Series **TREND NOVO**

Series **TREND RUSTICO**

Series **TREND RUSTICO**

WOOD ENTRANCE DOORS **INO-HH**

thickness 68/ 68-95 mm

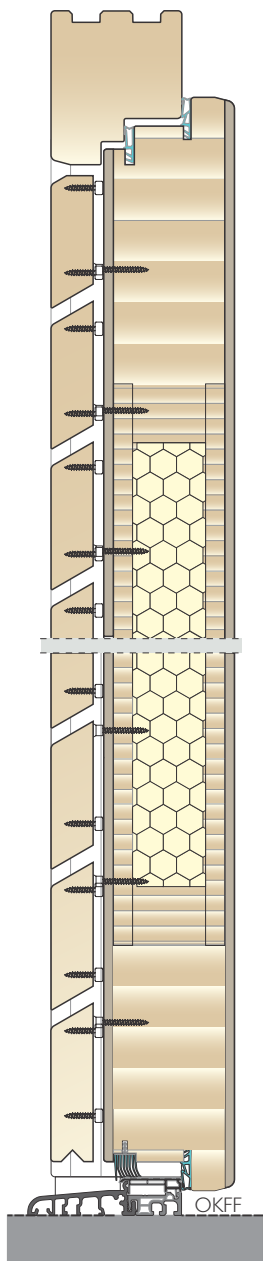

Series **TREND LINE**

thickness 68/ 68 mm

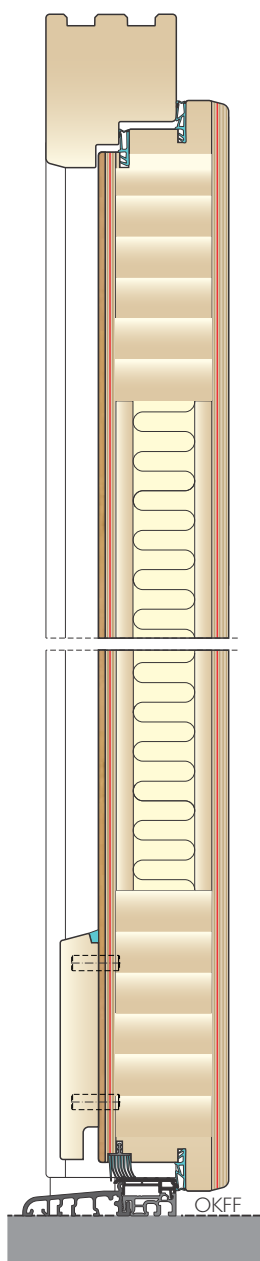

Series **TREND HBF**

thickness 68/ 68 mm

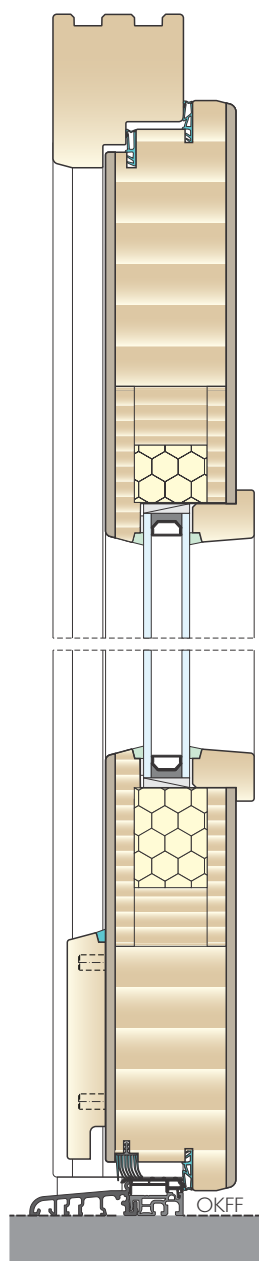

Series **TREND**

thickness 68/ 68 mm

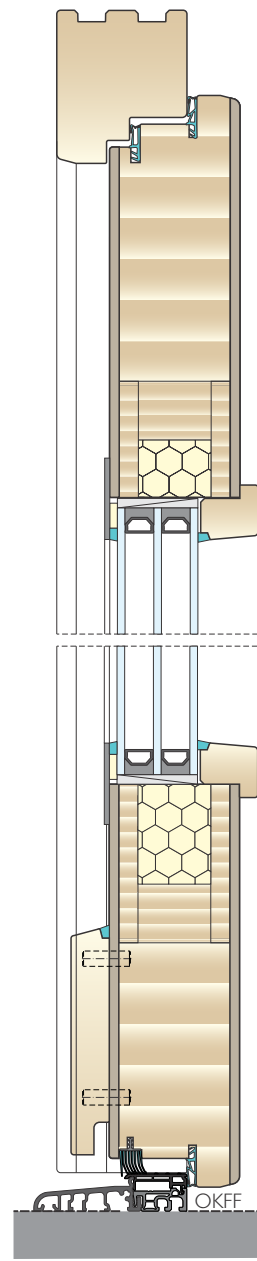

Series **DELUXE**

WOOD ENTRANCE DOORS **INO-HH**

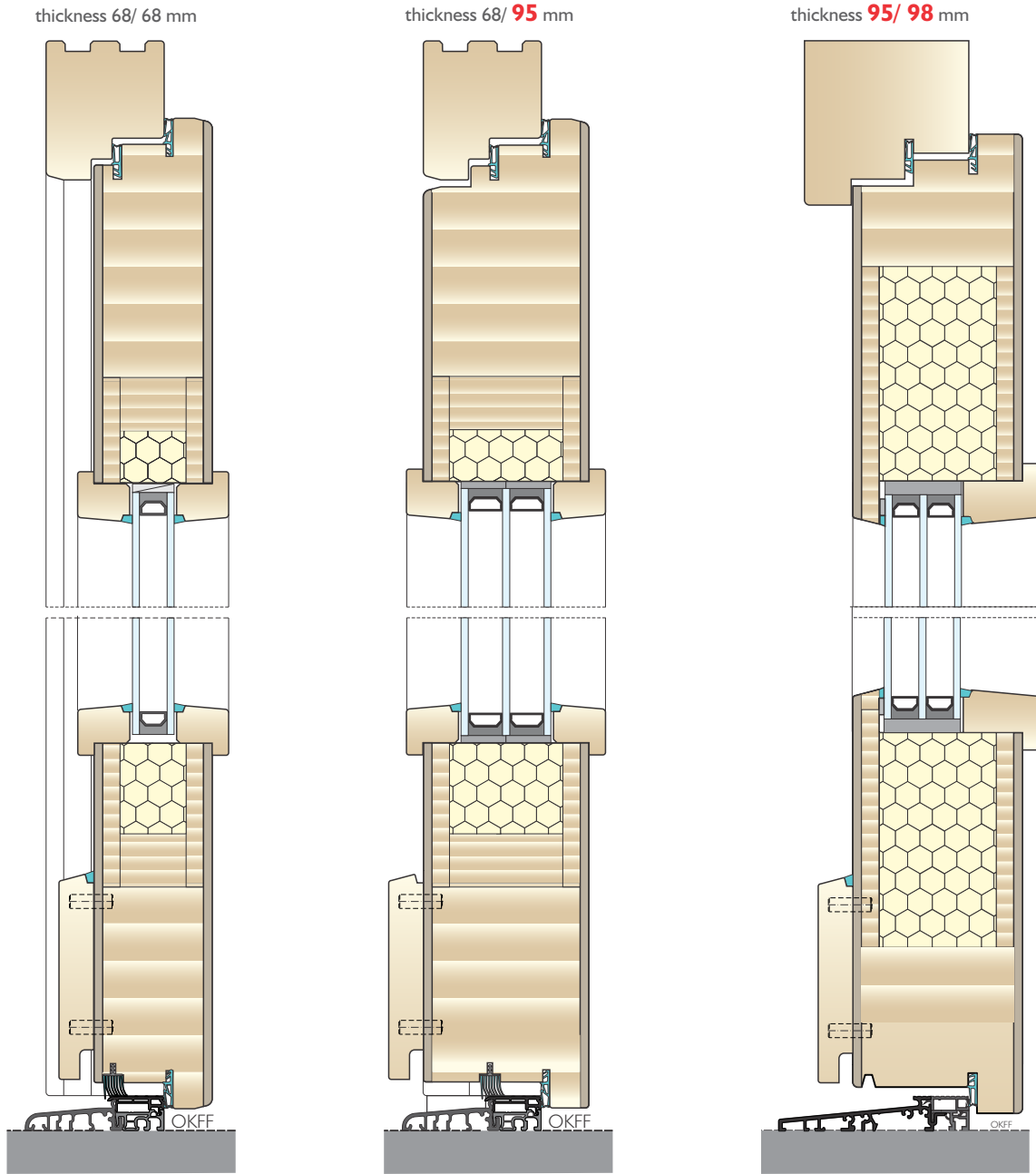

Series **MODERN**

Model **TREND, HT 100**
Series **MODERN**

LOW ENERGY

Model **TREND, HT 264**

PASSIVE

CROSS SECTIONS

WOOD/ALUMINIUM ENTRANCE DOORS **INO-HAH**

Solid wood
thickness 68 mm

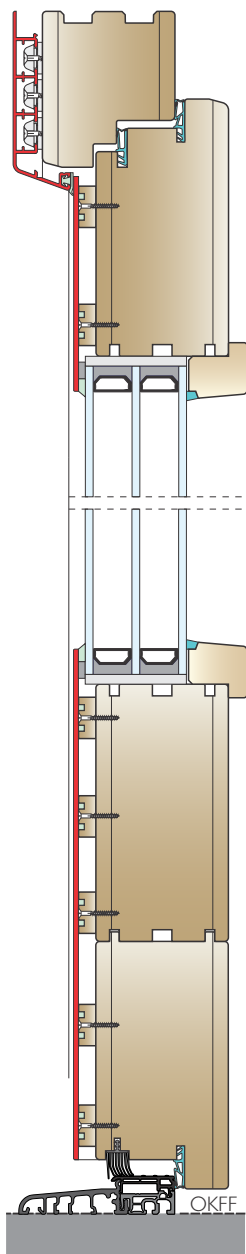

Series **KLASSICO**
(Due to technical reasons not
all models are available.)

WOOD ENTRANCE DOORS **INO-HH**

Solid wood
thickness 80/ 80 mm

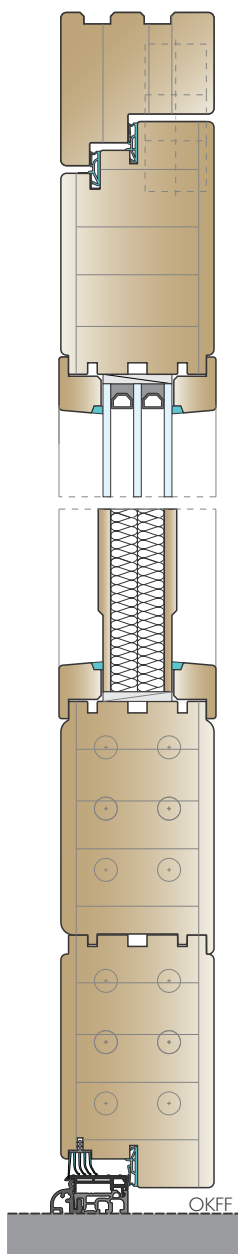

Series **KLASSICO ETA**

Solid wood
thickness 68/ 68 mm

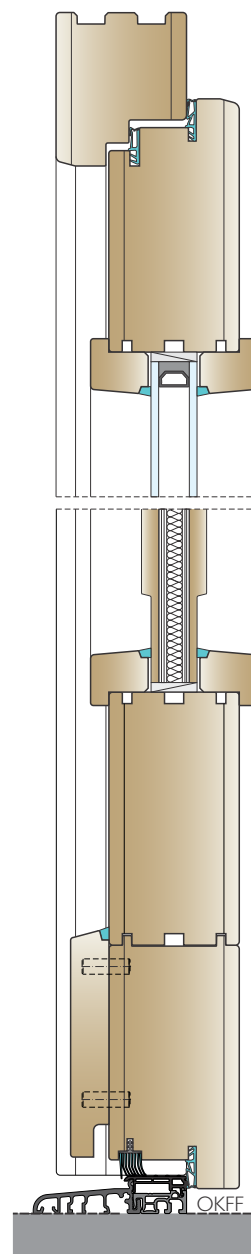

Series **ANTICO,
RUSTICO, KLASSICO,
NEOKLASSICO**

WOOD ENTRANCE DOORS **INO-HH**

STANDARD VERSION
ANGULAR EDGES
 (glazing bar, weatherboard)
BKV 80 TB threshold

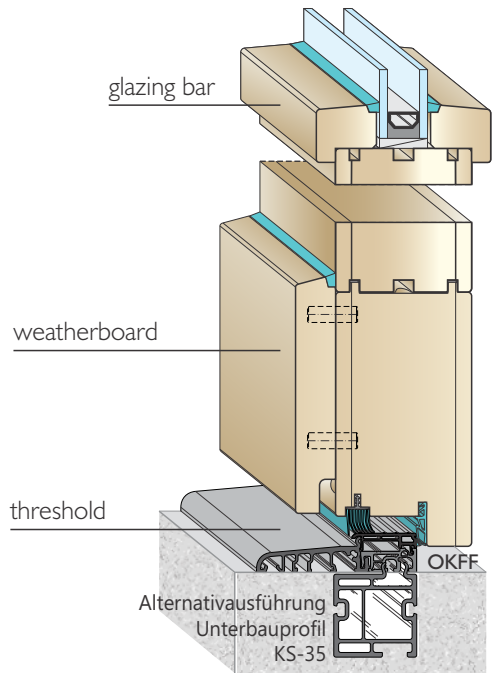

STANDARD VERSION HH 80
BKV 40 TB threshold

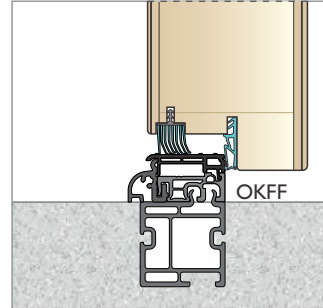

ADDITIONAL OFFER HH 80
BKV 80 TB threshold

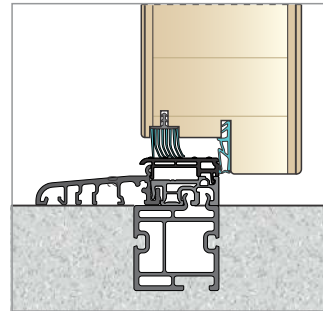

ADDITIONAL OFFER
 (glazing bar, weatherboard)
AV-02 threshold

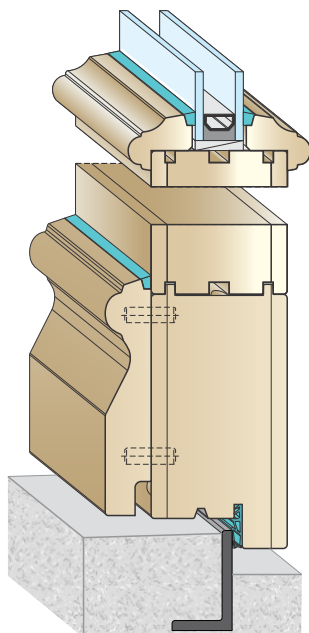

ADDITIONAL OFFER
 (glazing bar, weatherboard)
AV-07 threshold

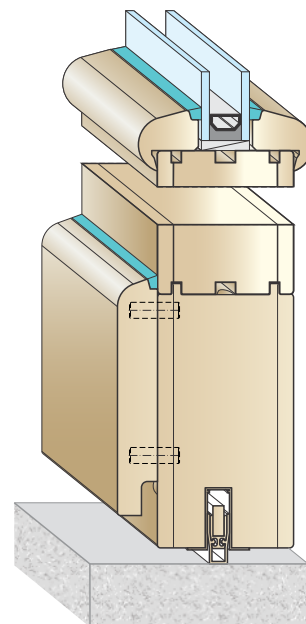

GLAZING

Ornamental glass



Kathedral K. WHITE



Chinchilla white

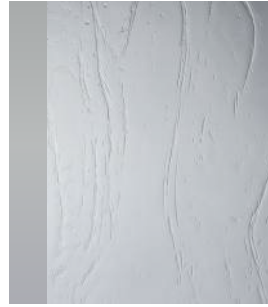

Gothic white

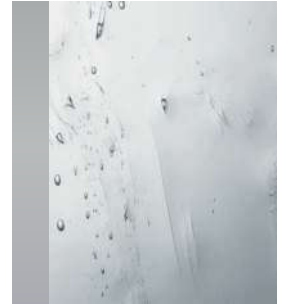

Altdeutsch K white

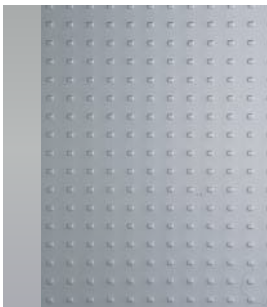

Mastercarre white



Masterligne white

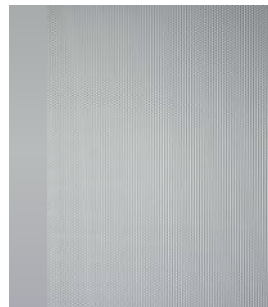

Masterpoint white

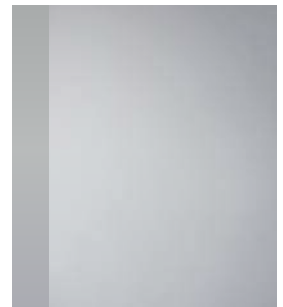

Satinato white

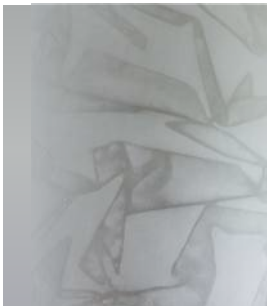

Silk white

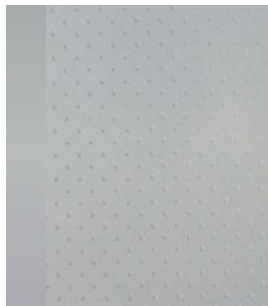

Pave white

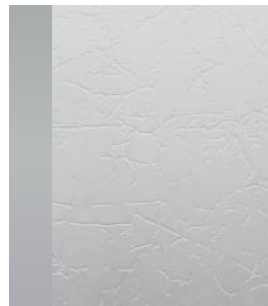

Uadi white

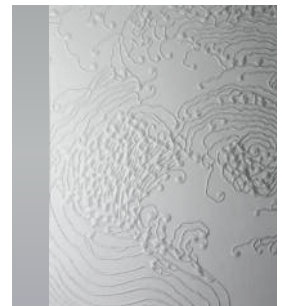

Nebulosa white

THERMAL INSULATING GLASS

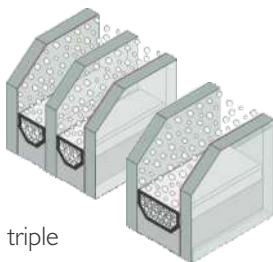

triple

twice

SANDBLASTED GLASS

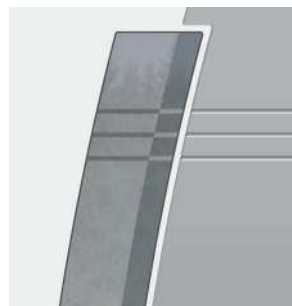
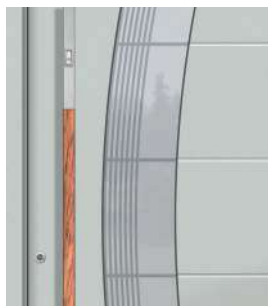

HANDLES

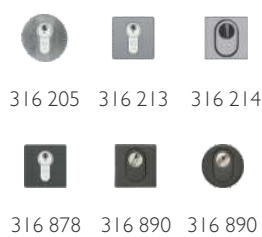
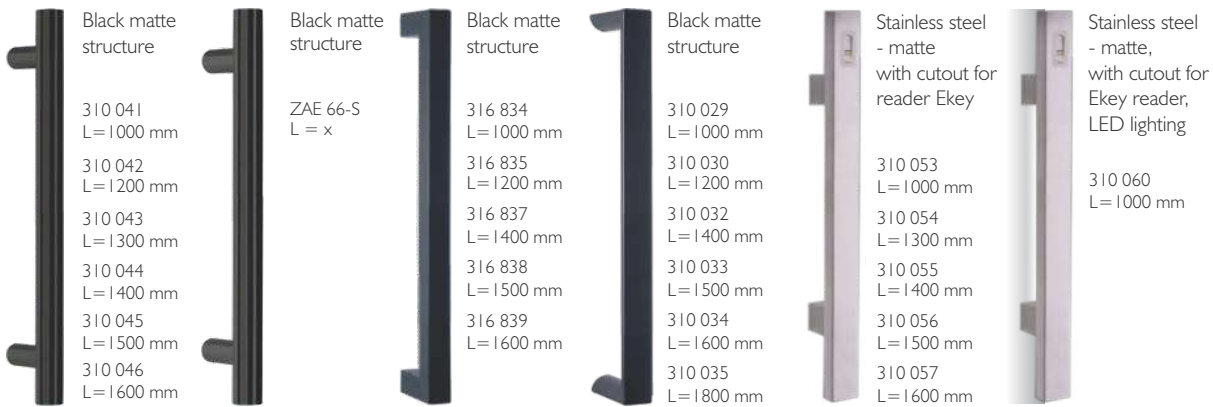

J 137 flush-mounted

Integrated handle strip - RAL color; Visible gap = 45mm

Length in mm according to request

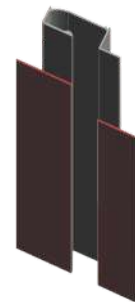

COLOUR CHART OF WOOD SURFACES

For wood and wood/aluminium windows and doors

The following wood species are available



Glazes (visible wood species structure)

Spruce/pine

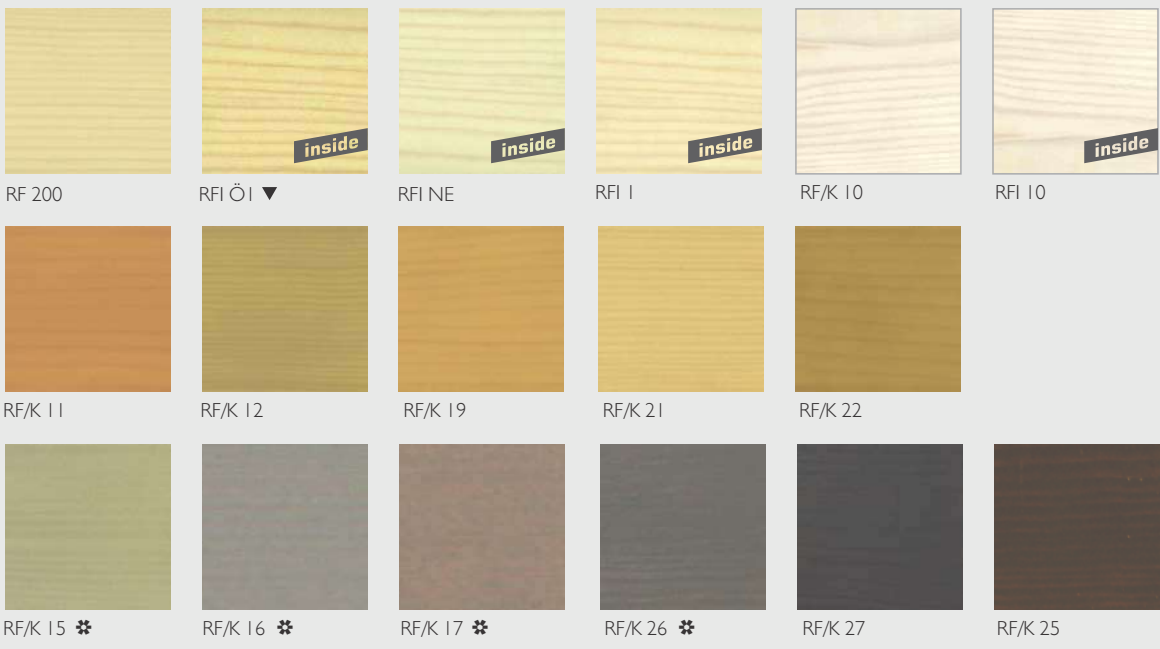

Pine



Basic



Larch

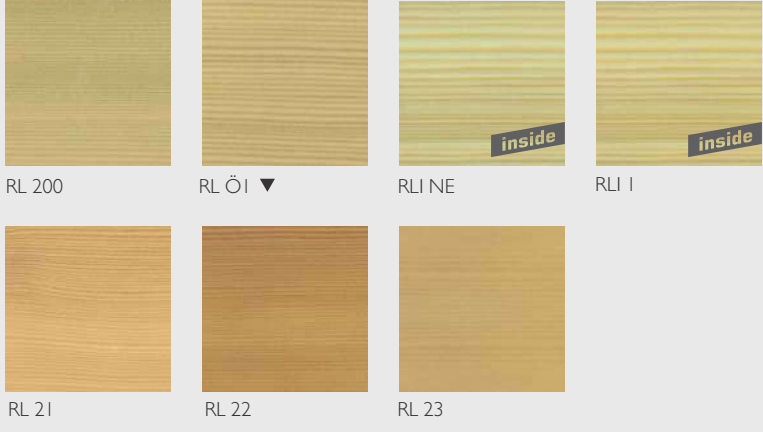

ENVIRONMENTALLY-FRIENDLY
 We use environmentally-friendly Water-based coatings for our three-layered system of surface treatment.

Oak



ALTHOLZ

ALTHOLZ WOOD DECOR

Available for two models: HT 100, HTA 100

Surface treatment: raw, oiled or basic



RE 200

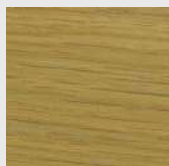

RE Ö1 ▼

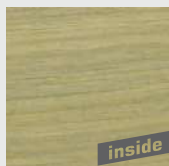

REI NE



REI I



REI 10

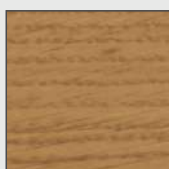

RE 21

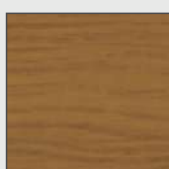

RE 22

Meranti



RM 21



RM 22



RM 23



RM 24



RM 25



RM 30



RM 31



RM 32

According to the RAL colour chart

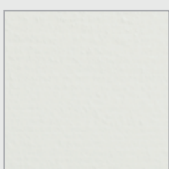

R D 21



R D 22



R D 25

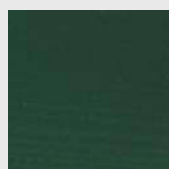

R D 44

NOTE:

▼ **OILED SURFACE** On the surface treated with oil we make no guarantees. The products like this requires at least 2x annual coating with a suitable oil, which you can buy from us.

✳ **COLORS RF/K 15, RF/K 16, RF/K 17, RF/K 26 and RK 1, RK 2, RK 4**

This shade strongly emphasizes the wood grain and is therefore more sensitive to possible color deviations, different hues and staining, which can occur due to different wood structures, restored resin bales and other manufacturing-related characteristics. Wood is a natural product, so after such a surface treatment with a more pigmented primer, the different absorption of the wood due to its unique shape and structure creates a playful combination of colours. This does not mean a reduction in the quality of the natural product wood nor that such colour differences can be a reason for a complaint about wood products.

COLOUR CHART OF ALUMINIUM SURFACES, HANDLES

Colours of aluminium for wood and wood/aluminium windows and doors

MASTER COLLECTION (finestruktur, metallic)



Night Grey
Feinstruktur Metallic



Cast Iron
Feinstruktur Metallic



Russet Copper
Feinstruktur Metallic



Brown
Feinstruktur Metallic

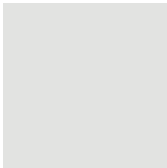

Artic Ice
Feinstruktur Metallic



Granit Nature
Feinstruktur Metallic



Volcanic Ash
Feinstruktur Metallic

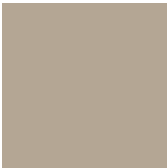

Precious Sand
Feinstruktur Metallic

ANODIZING COLLECTION (matt, metallic)

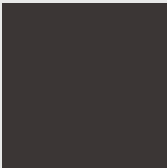

CARBON NIGHT
Matt Metallic

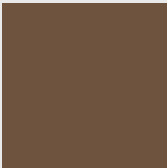

DARK COPPER
Matt Metallic



SIMPLY COPPER
Matt Metallic



ORIGINAL PLATINIUM
Matt Metallic



GSPED 0
Matt



GSPED 1
Matt

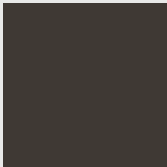

GSPED 4
Matt

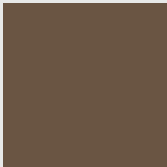

NOBLE BRONZE
Matt Metallic

RAL FARBEN (matt, finestruktur, metallic, glatt)

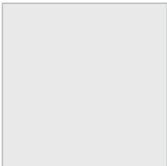

RAL 9016
Matt/ Feinstruktur

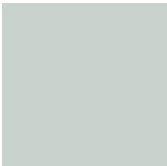

RAL 7035
Matt/ Feinstruktur



RAL 7004
Matt/ Feinstruktur



RAL 7016
Matt/ Feinstruktur

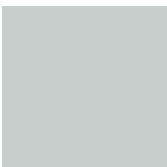

RAL 9006
Metallic glatt



RAL 9007
Metallic glatt



DB 703
Metallic glatt



DB 703
Metallic Feinstruktur

Imitation in stone



Dekor Zement hell



Dekor Beton dunkel

Imitation in wood



Dekor Altholz
(Stadelholz-1N)



Dekor Stadelholz grau

GS Stemeseder Imitation wood

IMITATION
IN WOOD

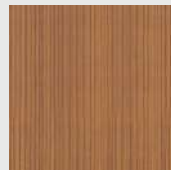

Douglas 7

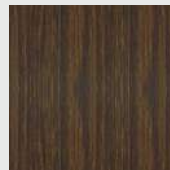

Eiche dunkel

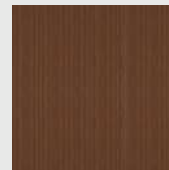

Kirsch 2

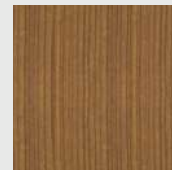

Kirsch 3

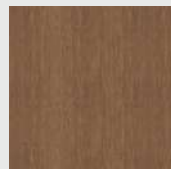

Golden Oak

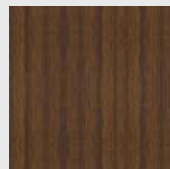

Nuss 1

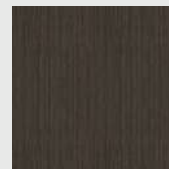

Wenge

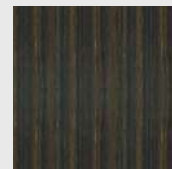

Walnuss dunkel

Inles d.d.

SI - 1310 Ribnica, Kolodvorska 22
tel.: 01 8377 100, fax: 01 8377 333

e-mail: info@inles.si



www.inles.si